

SHIMANO

1987 REPAIR MANUAL

Shimano American Corporation, One Shimano
Irvine, CA 92718

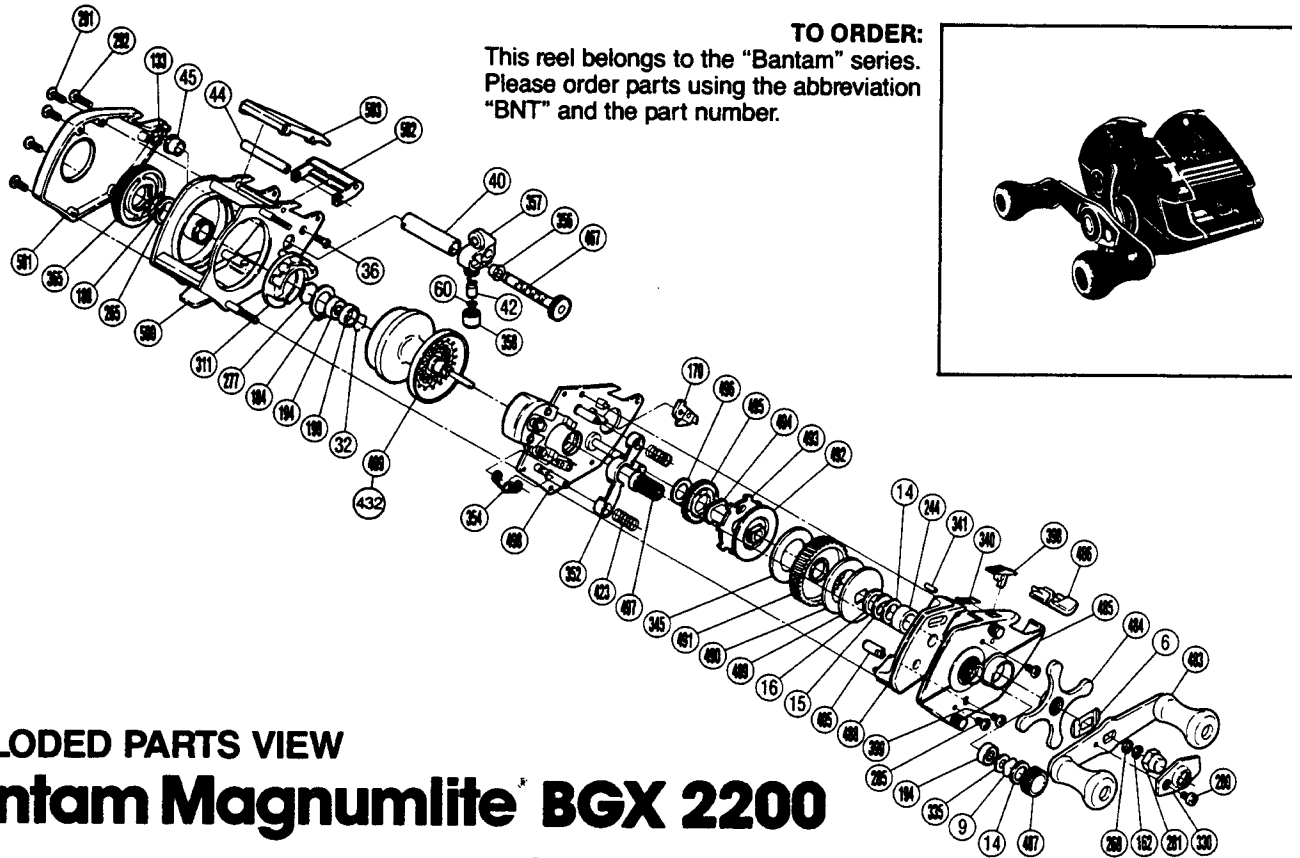

TO ORDER:
This reel belongs to the "Bantam" series.
Please order parts using the abbreviation
"BNT" and the part number.

EXPLODED PARTS VIEW

Bantam Magnumlite BGX 2200

PARTS LIST

PART #	DESCRIPTION	PART #	DESCRIPTION	PART #	DESCRIPTION
6.	Friction Washer "A"	277.	Bearing Spacer "B"	467.	Worm Shaft
9.	Cast Control Spacer	280.	Handle Nut Plate Screw	483.	Handle Assembly
14.	Friction Washer "B"	281.	Handle Nut	484.	Star Drag
15.	Drag Spring Washer	285.	Right Side Plate Screw	485.	Right Side Plate
16.	Friction Washer "C"	291.	Left Side Plate Screw	486.	Right Side Plate Cover
32.	Bearing Retainer	292.	Stabilizer Bar Screw "B"	487.	Cast Control Cap
36.	Stabilizer Bar Screw "A"	311.	Magnet Retainer	488.	Clutch Button Attachment
40.	Level Wind Guard	330.	Handle Nut Plate	489.	Key Washer "A"
42.	Line Guide Pawl	335.	Bearing Washer "A"	490.	Drag Washer
44.	Stabilizer Bar	340.	Switch Spring	491.	Drive Gear
45.	Worm Bearing "B"	341.	Switch Spring Lock	492.	Key Washer "B"
60.	Spacer (optional)	345.	Drive Shaft Washer "B"	493.	Anti-Reverse Ratchet
133.	Worm Shaft Retainer	352.	Yoke	494.	Drive Shaft
162.	Drive Shaft Retainer	354.	Retractor Spring	495.	Idle Gear
170.	Anti-Reverse Pawl	356.	Worm Bearing "A"	496.	Drive Shaft Washer "C"
184.	Magnet Retainer Lock	357.	Line Guide	497.	Pinion Gear
188.	O Ring	358.	Pawl Cap	498.	Set Plate Assembly
194.	Ball Bearing	365.	Magnetic Control Dial	499.	Spool (standard-V)
198.	Bearing Spacer	398.	Anti-Reverse Switch	500.	Frame
244.	Bushing	399.	Retractor Guide Screw	501.	Left Side Plate
265.	Spacer (optional)	405.	Retractor Guide	502.	Level Wind Protector
268.	Drive Shaft Washer "A"	423.	Yoke Spring	503.	Thumb Rest
		432.	Spool (optional large capacity)		